

# Accessories - Flexible Couplings

## Flexible Shaft Couplings Description

To attach an encoder shaft to another rotating shaft, a coupling device is needed. Because shaft run-out or endplay can result in excessive loads on encoder bearings, BEPC recommends use of flexible couplings designed for encoder applications. It's far more cost-effective to replace a coupling than to replace an entire encoder.

The Primary job of couplings is to join together two pieces of rotating equipment while permitting some degree of misalignment or end movement or even both. By careful selection, installation and maintenance of couplings, substantial savings can be made in reduced maintenance costs and downtime and will help prolong your equipment's life.



A Photograph Example of our Coupling Selections

## Popular Flexible Coupling Options

Here is a selection chart and Diagram showing our most popular Flexible Couplings and the Dimension/Order Codes

Dim "X"	Dim "Y"	Dim "A"	Dim "B"	Use Order Code
32.00mm	40.00mm	12.00mm	12.00mm	CPA/12/12
25.00mm	32.00mm	10.00mm	10.00mm	CPA/10/10
25.00mm	32.00mm	10.00mm	6.00mm	CPA/10/6
25.00mm	32.00mm	10.00mm	0.250"	CPA/10/4
25.00mm	32.00mm	0.375"	0.375"	CPA/S/S
25.00mm	32.00mm	0.375"	0.250"	CPA/S/4
25.00mm	32.00mm	0.375"	6.00mm	CPA/S/6
25.00mm	32.00mm	0.250"	0.250"	CPA/4/4
20.00mm	28.00mm	6.00mm	6.00mm	CPA/6/6
16.00mm	17.00mm	6.00mm	6.00mm	HEL/6/6

Non-Stock Bore sizes can be manufactured to customer requirements. call the sales office for price and delivery.

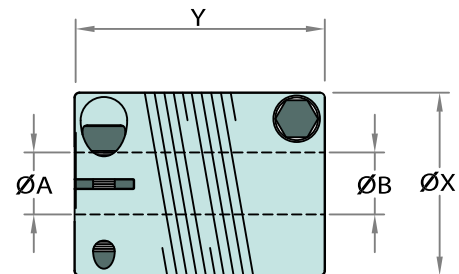

## Rubber Flexible Coupling Option

Here is a chart and Diagram showing our popular Rubber Flexible Couplings and the Dimension/Order Code

Dim "X"	Dim "Y"	Dim "A"	Dim "B"	Dim "C"	Use Order Code
48.00mm	45.00mm	10.00mm	10.00mm	9.00mm	CDL/10/10

