

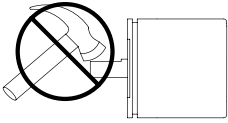

**BRITISH  
ENCODER**  
PRODUCTS COMPANY



## SA36/MA36 Installation Information



Do not shock or strike.

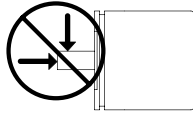

Do not subject shaft to excessive axial or radial shaft stresses.

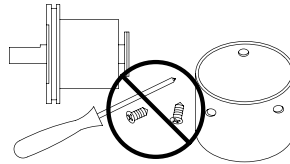

Do not disassemble.

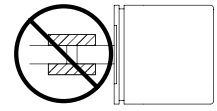

Do not use a rigid coupling.

### Hollow Shaft Mounting (MA/SA36H)

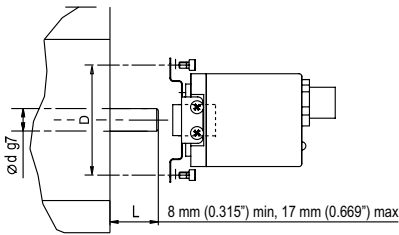

#### STEP 1

Slide the encoder over the motor shaft.

#### DO NOT USE UNDUE FORCE

Position the encoder so that the flex mount arms just touch the mounting surface. Install two screws through the holes in the flex mount and tighten securely. (Typical torque range of 115 to 160 oz-in). For additional security, add a drop of Loctite 222 to the threads of the screws.

#### STEP 2

Tighten the setscrew in the encoder's shaft. (Typical torque range of 50 to 80 oz-in). For additional security, add a drop of Loctite 222 to the threads of the setscrew. Do not allow Loctite to run into the bore or onto the bearings.

#### STEP 3 (Slotted flex mount option only)

For encoders with the slotted flex mount option, fine-tune the home position by loosening the mounting screws and rotating the encoder to the desired position, then retightening the screws.

Alignment note: When turning the motor shaft by hand, the rocking movement of the encoder should be minimal. If it isn't, loosen the encoder bore set screw and rotate the encoder shaft relative to the motor shaft to reposition the encoder until this movement is minimal.

### CANopen Wiring

Function	Pin
+VDC	2
Ground (GND)	3
CAN <sub>High</sub>	4
CAN <sub>Low</sub>	5
CAN <sub>GND</sub> / shield	1

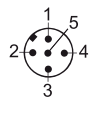

### Solid Shaft Mounting

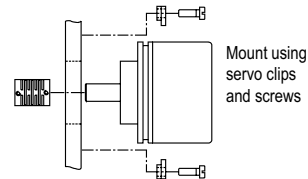

Mount using servo clips and screws

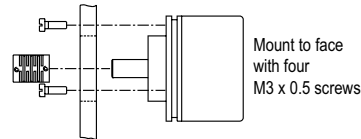

Mount to face with four M3 x 0.5 screws

### SSI Wiring

	Cable	8-pin M12
Ground	white	1
+VDC	brown	2
SSI CLK+	green	3
SSI CLK-	yellow	4
SSI DATA+	gray	5
SSI DATA-	pink	6
PRESET	blue	7
DIR	red	8
Shield		housing

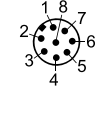

MA/SA36 SSI Installation Rev A. 03/2011