

Accessories - Mountings, Flanges Brackets & Misc

British Encoder Products Accessories :-

British Encoder Products Company offers a wide range of accessory items to help you complete your encoder application. In many instances, it's necessary to position a rotary encoder with a mounting bracket or Flange in order to obtain the desired feedback. BEPC offers mounting brackets for a number of Encoder models. All BEPC brackets are manufactured of durable materials and have the proper mounting holes and geometry for easy application to our encoders.

Below are charts showing a selection of our available fixing options, We also have a selection of options not shown here and can also offer modified versions to suit your individual needs to allow you to replace a competitors model with one of our own.



A Photograph Example of our some of our Selections

Popular Fixed Brackets and Flanges

Description	To Fit Encoder :-	Order Code
725/925 "L" Bracket	730, 725, 925	M-3
740 STD "L" Bracket	745 STD	M-4
758/958-20 "L" Bracket	758-20, 958-20	M-B
758/958-26 "L" Bracket	758-26, 958-26	M-M
725 "L" Bracket	730, 725, 925	M-G
725/758-20 "L" Bracket	730, 725, 925, 758-20	M-J
TR1 Mounting Bracket	TR1, Tru Trac	140104
Uni-Bracket	260, 702	175997-1
725 Square Flange	730, 725, 925	175123
L25G Flange	730, 725, 925	M-7
L+B,MR Universal Flange	730, 725, 925	W0123
"Gaebridge Style" 60L Flange	730, 725, 925	W0791
"Gaebridge Style" 30L Flange	730, 725, 925	W0224
"Gaebridge Style" 35L Flange	730, 725, 925	W0239
"Gaebridge Style" 33L Flange	730, 725, 925	W0224-1
ETS Flange	730, 725, 925	W0392
Gelma Flange	730, 725, 925	W0517
58 Type Square Flange S/Steel	758-20 type	W0166-2
M-2 Flange	730, 725, 925	M-2

Tru-Trac 3 Series Brackets

Description	To Fit Encoder :-	Order Code
TR3 Mounting Bracket	Tru-Trac 3	176389-01
TR3 Double Wheel Pivot	Tru-Trac 3	176391-01

Pivot Arm's and Blocks

Description	To Fit Encoder :-	Order Code
Pivot Block	758-26, 958-26	M-F
Bracket Arm Assembly	730, 725, 925	M-H

755 Series Flanges

Description	To Fit Encoder :-	Order Code
MHH Flange	755-RG	M-1
Parvex Flange	755-HS	M-9
Square Flange	755-RG	M-A

More Information

Please visit our website www.encoder.co.uk for more information regarding our range of accessories including downloadable dimension drawings of a selection of the above mounting options. For even more information please dont hesitate to call our sales team who will be more than happy to discuss your mounting option needs.

Accessories - Mountings, Flanges Brackets & Misc

PIVOT BRACKET OPTIONS :-

FOR MOST LINEAR MEASUREMENT APPLICATIONS, our line of Tru-Trac® encoders is a great option. These integrated linear measurement solutions are easy to install and deliver reliable, accurate feedback for applications such as cut-to-length, spooling, length measurement, and print registration.

Occasionally, though, there is a linear measurement application that requires something our Tru- Trac® encoders don't offer. Maybe you need absolute feedback. Maybe you need an additional bearing load. Maybe you need the encoder to be programmable.

If your application calls for any of those options, we have another solution: a bracket that turns a Standard encoder into a linear measurement solution.

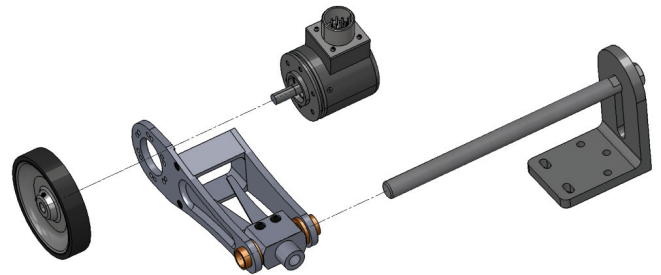

Description	To Fit Encoder	Order Code
Single Pivot Bracket (No Spring)	711 / 716 / 711I / 716I	176430-01
Single Pivot Bracket (w/Spring)	711 / 716 / 711I / 716I	176430-02
Double Pivot Bracket (No Spring)	711 / 716 / 711I / 716I	176431-01
Double Pivot Bracket (w/Spring)	711 / 716 / 711I / 716I	176431-02
Single Pivot Bracket for Square Flange Encoder	25SF, 25SP, 702, 725, A25SB (2.5")	176727-01
Spring Loaded Pivot Bracket for Square Flange Encoder	25SF, 25SP, 702, 725, A25SB (2.5")	176727-02
Spring Loaded Pivot Bracket for Servo Mount/Clamping Flange Encoder	25SP, A58SE, A25SB	176742-02



Stock # 176389-01 – Angle Mounting Bracket

This bracket simplifies installation of your linear measurement solution. Designed specifically for BEPC products, this bracket allows you to mount and install your encoder, bracket, and measuring wheel solution quickly and easily, without having to design, machine, or source a mounting solution.

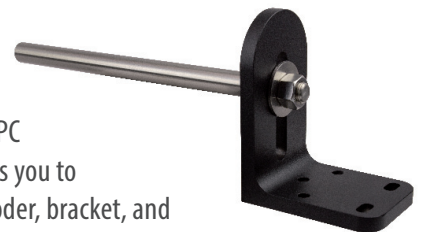

MISC. ACCESSORIES

FLEX-MOUNT KITS

Flex-Mount kits are available for any Encoder that we supply with a Flex-Mount fixing - Please see the correct Encoder page then contact the sales office to order the kit for the Flex-Mount number you are interested in buying (i.e. a kit for the 260 SF mount)

PROTECTIVE COVERS

Order No:

175996-01.....	Uni-Cover Kit (Includes bolts and washers). Compatible with models 121, 260, 755A, 702, 775, 776 and 960
770-000-02.....	770 Protective Cover Kit (includes mounting hardware) IP65 Sealing
865-000-02.....	865T Protective Cover Kit (includes mounting hardware) IP65 Sealing
176301-01.....	56C Cage Style Cover Kit for Model 25T and Model 260 (Includes bolts and washers.)

C-FACE GASKET KITS

Order No:

770-Gasket-Kit.....	C-Face Gasket Kit for Model 770
121-Gasket-Kit.....	121 Base Dust Seal (IP50)



SERVO CLAMPS

Order No:

140083.....	Servo Clamp - Top Mount (one clamp w/ one 4-40 screw) for models 755A, 702, 725, 758-26, 925 and 958-26 Servo Hubs.
-------------	---

